

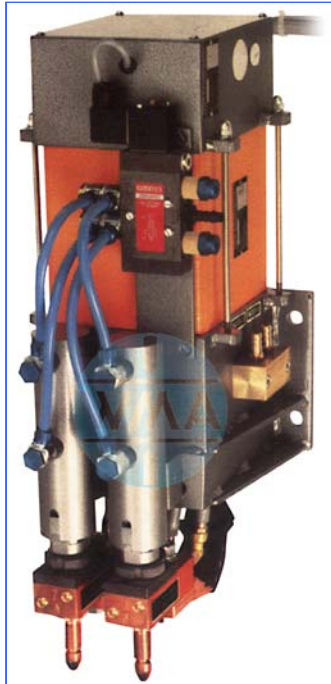

Twin spot welding head LD22

Version: 01-2011



pneumatic operated and water-cooled twin spot welding head for many different welding tasks

- ease of assembly with all standard welding machines
- welding of all types of sheet metal without any problems
- faultless welding of galvanized sheets by controlled current pulse rate and lowering current
- easy to connect to the supply of the welding machine
- quick electrode cap removal
- solid design

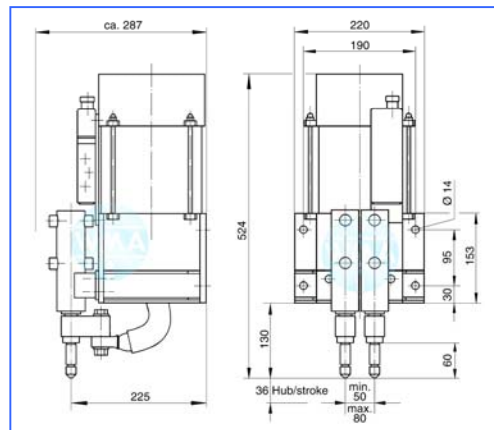

	LD22
Nominal power (at 50% ED)	22 kVA
Connection power	58.2 kVA
Nominal primary voltage	380 V
Nominal frequency	50 Hz
Fuse (delayed action)	63 A
Terminal cross-section	16 mm ²
Secondary open-circuit voltage	5 V
Secondary short circuit current	18 kA
Maximum welding current	14.4 kA
Space between the points	50-80 mm
Stroke	36 mm
Electrode force at 6 bar	2 x 100 daN
Dimensions: Depth	290 mm
Width	220 mm
Height	524 mm
Weight	50 kg
Order-number	ZWMALD22-001

The twin spot welding head LD22 can be controlled by different welding controls.

We reserve the right to make changes which are in the interest of technical progress.

© by WMA Schmidt & Bittner GmbH, Baumwaide 23, D-74360 Ilsfeld-Auenstein, Tel. +49 7062 9066-0, Fax +49 7062 9066-20
 info@wma-sb.de or wma-sb@t-online.de, <http://www.wma-sb.de>

LD22-1