



CL 292

Version: 01-2011

pneumatically operated, water cooled* C spot welding gun

- compact design
- double stroke mechanism
- transformer, fully encapsulated in plastic
- contact pressure function in the handle
- cardan suspension
- gun with 4 m power supply cable and switch
- low-maintenance design

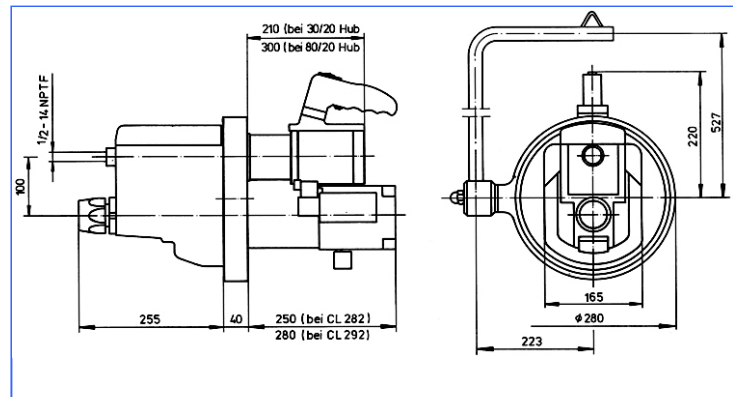
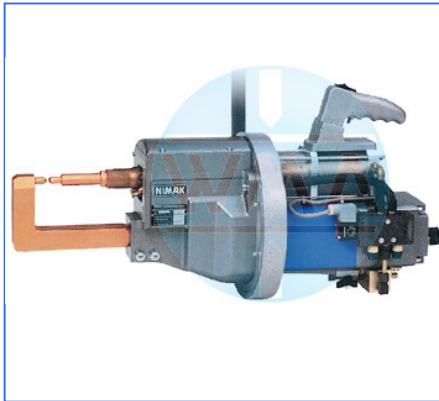

	CL 292-2
Welding performance*	3 + 3 mm
Rated power (at 50% ED)	22 kVA
Supply power	47.4 kVA
Connection section	16 mm ²
Fuse, delayed action	63 A
max. welding current	13,2 kA
Electrode force at 6 bar	400 daN
Arm spacing	100 mm
Depth of throat	180 mm
Stroke (WCS / WS)**	30 / 15 mm
Weight (without electrode arms)	49 kg
Order-number	XK4.112.C00

* The welding performance data quoted refer to steel, non-continuous machining.

** Stroke (WCS / WS) 80 / 20 mm available for an additional charge.

Different welding controls can be used.

*This kit does not include a water chiller!

WMA is general distributor for NIMAK welding machines in Baden-Wuerttemberg

We reserve the right to make changes which are in the interest of technical progress.

© by WMA Schmidt & Bittner GmbH, Baumwaide 23, D-74360 Ilsfeld-Auenstein, Tel. +49 7062 9066-0, Fax +49 7062 9066-20
info@wma-sb.de or wma-sb@t-online.de, <http://www.wma-sb.de>

CL292-1



CL 292

Version: 01-2011

Optional hand grips for spot welding guns

Standard grip



integrated grip with two additional switches



Hand grip with digital switch



Optional locking lever

