



NMP 7/80-160

Version: 01-2011

Pneumatically operated, water cooled* stationary seam welding machines

- traverse and longitudinal seam versions
- vertical arm spacing can be adjusted hydraulically
- electrode force can be regulated with a switch
- with a compressed air maintenance unit
- driven by an upper seam welding roller
- separately adjustable cooling water circuits with flow and temperature display

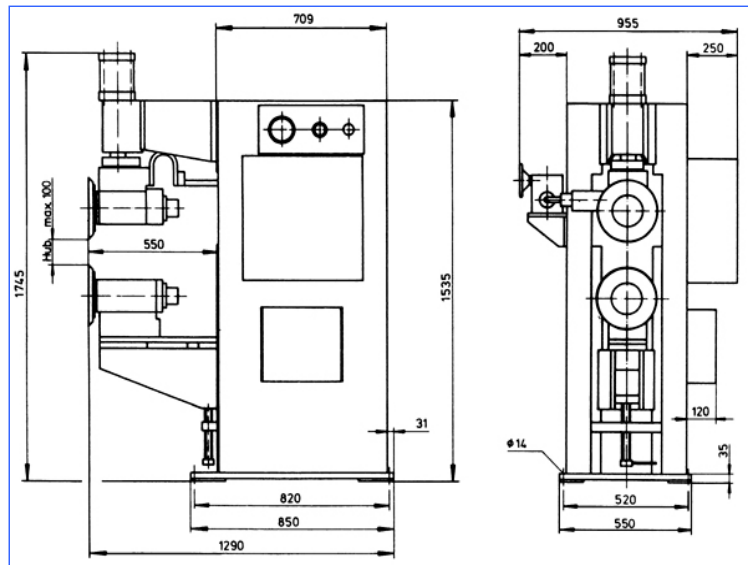

	NMP 7/80	NMP 7/100	NMP 7/125	NMP 7/160
Welding performance*	1.25 + 1.25 mm	1.5 + 1.5 mm	2 + 2 mm	
Nominal capacity (at 50% ED)	80 kVA	100 kVA	125 kVA	160 kVA
Supply power	109 kVA	154 kVA	196 kVA	
Connection section	70 mm ²	95 mm ²	120 mm ²	
Fuse, delayed action	160 A	200 A	250 A	
max. welding current	20 kA	24.8 kA	29.6 kA	
Electrode force	145-870 daN	145-870 daN	145-870 daN	860 daN
Depth of throat	550-1050 mm	550-1050 mm	550-1050 mm	550 mm
Electrode stroke	100 mm	100 mm	100 mm	100 mm
Order-number	XP0.128.C01	XP0.130.C01	XP0.131.C01	XP0.134.C01

* The max. welding values quoted refer to sheet steel.

Standard design; Order-number from type NMP 7QL/160 with combined traverse and longitudinal seam.

Different welding controllers can be used.

*This kit does not include a water chiller!

WMA is general distributor for NIMAK welding machines in Baden-Wuerttemberg.

We reserve the right to make changes which are in the interest of technical progress.

© by WMA Schmidt & Bittner GmbH, Baumwaide 23, D-74360 Illfeld-Auenstein, Tel. +49 7062 9066-0, Fax +49 7062 9066-20
 info@wma-sb.de or wma-sb@t-online.de, <http://www.wma-sb.de>



NMP 7/80-160

Version: 01-2011

Optional designs (examples)

Seam welding machine
in traverse seam version



Seam welding machine
in longitudinal seam version

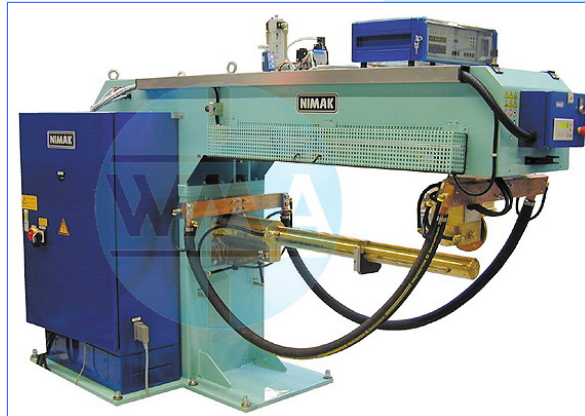

Tank seam welding machine



Shaving technique



WMA is general distributor for NIMAK welding machines in Baden Wuerttemberg.

We reserve the right to make changes which are in the interest of technical progress.

© by WMA Schmidt & Bittner GmbH, Baumwaide 23, D-74360 Illfeld-Auenstein, Tel. +49 7062 9066-0, Fax +49 7062 9066-20
info@wma-sb.de or wma-sb@t-online.de, <http://www.wma-sb.de>

NMP-2



NMP 7/80-160

Version: 01-2011

**Options,
the following devices and equipments can be built on:**

Flow controls

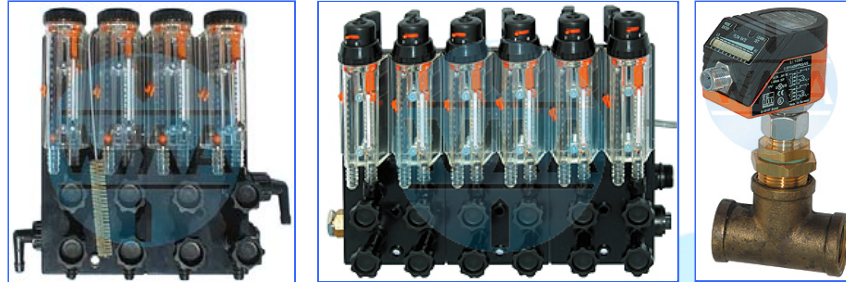

Measuring devices

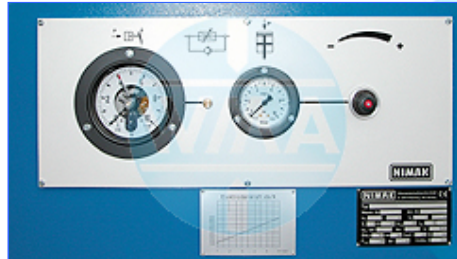

Water filters



Table height-adjustable with threaded rod and ratchet

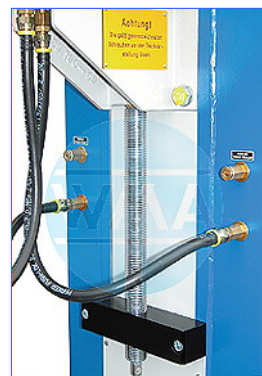

Supply cylinder with hand wheel



Lower arm supports



We reserve the right to make changes which are in the interest of technical progress.

© by WMA Schmidt & Bittner GmbH, Baumwaide 23, D-74360 Illfeld-Auenstein, Tel. +49 7062 9066-0, Fax +49 7062 9066-20
info@wma-sb.de or wma-sb@t-online.de, <http://www.wma-sb.de>